

**Dear Customer,**

This Quick Start Guide is enclosed with detailed washing machine operating instructions. **Before using the appliance carefully read the Operating Instructions, especially guidelines for safe use.**

Before plugging the washing machine into the mains, remove the safety packaging and ensure the machine is level. **Do not start the washing machine before it is properly set up.**

Only wash delicate fabrics, synthetics, wool using designated programs. Such fabrics should only be washed in the maximum load sizes recommended (see page 2).

The correct washing machine operation extends its lifetime so make sure the drum seal is dry (leave the door ajar after washing). Do not clean the washing machine with harsh or abrasive detergents.

**1 Preparing to wash**

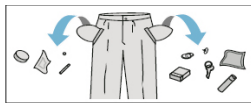

- Empty pockets
- Close all zips and button up duvet covers.
- Wash delicate and small items in a protective mesh laundry bag.
- Open the door of the washing machine by gripping the door and the door handle on the inside of the door.
- Insert the sorted clothes into the washing machine:
  - Cotton – max full drum.
  - Synthetics – max ½ of the drum.
  - Silk, wool – max ¼ of the drum.
- Close the door, press firmly against the seal.

**2 Add detergent**

- Open the detergent drawer. Pull the handle.
- Pour the recommended dose of washing detergent into the appropriate compartment of the detergent drawer.
- Add fabric conditioner to the appropriate compartment if required.
  - || MAIN WASH detergent.
  - ☼ Fabric softener or other special care liquids.
  - I PREWASH detergent.
- The OptiDose button is used for automated dispensing of liquid detergent. You can choose the detergent dose – small, medium, large – or turn off the system.
- Press and hold the OptiDose button for 3 seconds to turn off the OptiDose option. Press and hold the OptiDose button for 3 seconds again to turn on the OptiDose option.

\* Available on selected models

**3 Program selections**

- Set the programme selector knob to the desired programme.
- Customize the programme to your needs – you can change the temperature, spin speed, or enable additional features.
- Select additional functions. The additional functions are described on the control panel and in the "Table of Wash Programmes" (see page 2).

**4 Select START**

- Close the appliance door.
- Set the programme selector dial to the desired programme (see page 2).
- Select additional functions or wash cycle parameters as required – according to your needs.
- Select time remaining ranging from 1 to 24 hours.
- Then press the START/ PAUSE button

**5 End of the wash**

- End of the wash cycle is indicated by acoustic signal (if active). The display shows END and the door lock indicator light goes out.
- Close the water valve.
- Turn washing machine off.
- Unplug the appliance from the mains.
- Open the door and remove laundry. Once clothes are removed, leave the door slightly ajar to allow the drum seal to dry before the door is closed properly. Leave the detergent drawer compartment slightly ajar to allow it to dry.

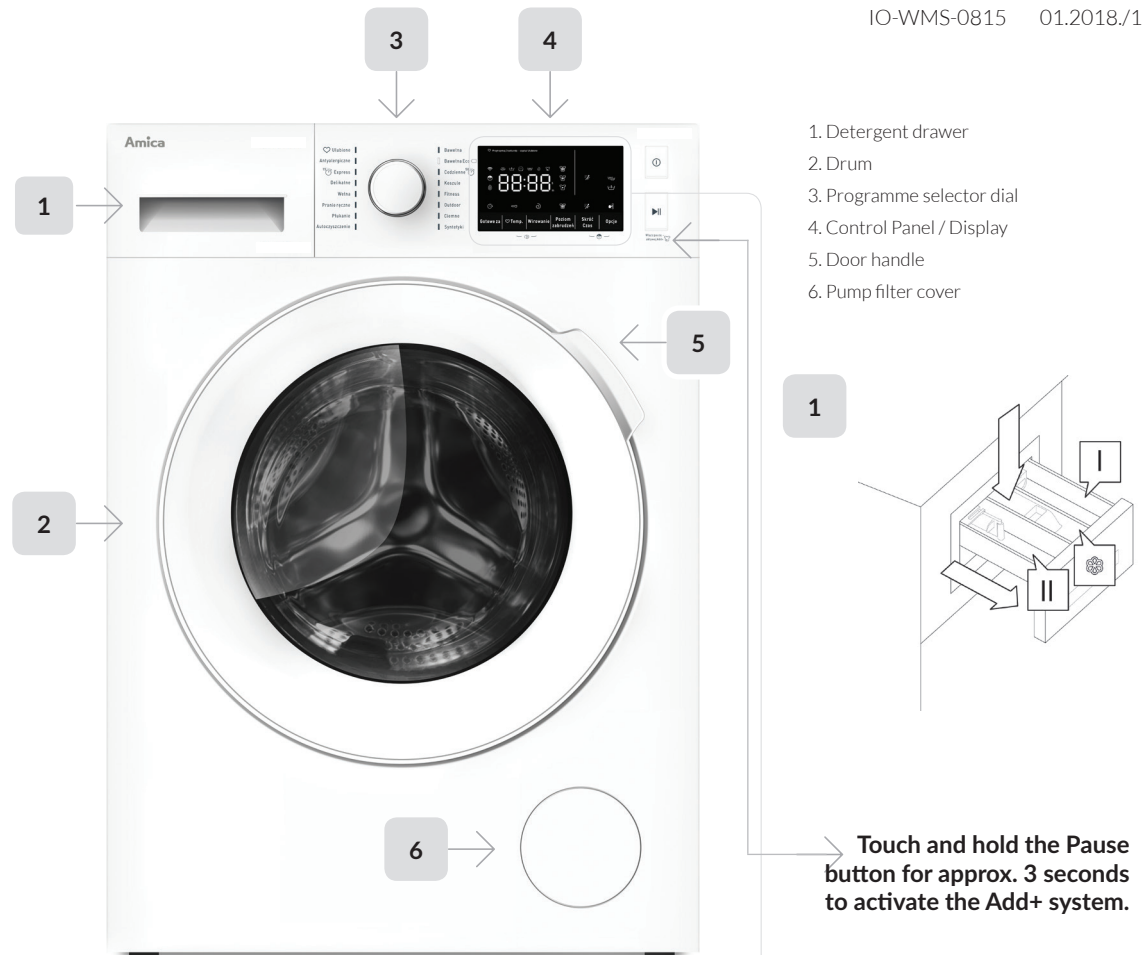

1. Detergent drawer
2. Drum
3. Programme selector dial
4. Control Panel / Display
5. Door handle
6. Pump filter cover

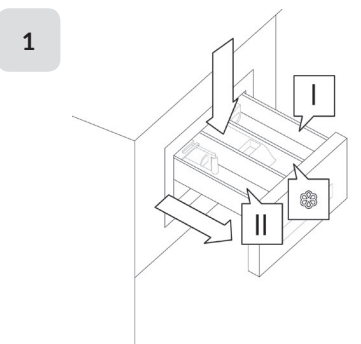

**Touch and hold the Pause button for approx. 3 seconds to activate the Add+ system.**

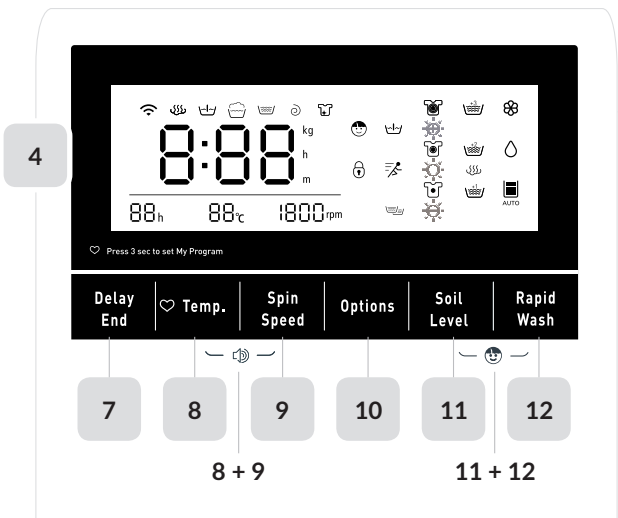

7. Time Remaining button
8. Temperature button
9. Spin Speed button
10. Options button
11. Soil Level button
12. Rapid Wash button

8+9. Acoustic Signal On/Off  
11+12. Child Lock

TABLE OF WASH PROGRAMMES: **WMS814 (WMAD5 8143C2BZD0W)**

| ITEM | Programme name | The default temperature [°C]                | Max. spin speed [RPM] | Max. load [kg] | Additional functions available      |                                     |                                     |                                     |                                     | Detergent drawer                    |                                     |                                     | Time [h:min] | Energy consumption [kWh] | Water consumption [l] | Number of rinses | Type of laundry  |
|------|----------------|---|-----------------------|----------------|-------------------------------------|-------------------------------------|-------------------------------------|-------------------------------------|-------------------------------------|-------------------------------------|-------------------------------------|-------------------------------------|--------------|--------------------------|-----------------------|------------------|--|
|      |                |   |                       |                | Steam                               | Rapid Wash                          | Extra Rinse                         | Prewash                             | Soil Level                          | Prewash I                           | Main wash II                        | Fabric softener®                    |              |                          |                       |                  |  |
| 1    | Cotton Eco     | 60°   | 1400                  | 8              |                                     |                                     |                                     |                                     |                                     | <input checked="" type="checkbox"/> | <input type="checkbox"/>            | <input type="checkbox"/>            | 04:34        | 0,73                     | 45                    | 2                | Moderately or heavily soiled cotton clothes, bed linen, table linen, undergarments, towels, linen fabrics.   |
| 2    | Cotton         | 40°   | 1400                  | 8              | <input checked="" type="checkbox"/> | <input checked="" type="checkbox"/> | <input checked="" type="checkbox"/> | <input checked="" type="checkbox"/> | <input checked="" type="checkbox"/> | <input type="checkbox"/>            | <input checked="" type="checkbox"/> | <input type="checkbox"/>            | 02:58        | 1,0595                   | 62                    | 2                | Heavily soiled clothing, or an moderately soiled cotton and linen for children that requires boiling.  |
| 3    | Everyday       | 60°   | 1400                  | 2              | <input checked="" type="checkbox"/> |                                     |                                     |                                     |                                     | <input checked="" type="checkbox"/> | <input type="checkbox"/>            | <input type="checkbox"/>            | 01:16        | 1,02                     | 62                    | 1                | Full and effective washing cycle in less than 1 hour. One of the shortest washing programmes on the market. Convenience and saving time  |
| 4    | Shirts         | 40°   | 800                   | 4              | <input checked="" type="checkbox"/> |                                     | <input checked="" type="checkbox"/> | <input checked="" type="checkbox"/> | <input checked="" type="checkbox"/> | <input type="checkbox"/>            | <input checked="" type="checkbox"/> | <input type="checkbox"/>            | 01:32        | 0,717                    | 32                    | 3                | Dirty cotton, clothing made from synthetic fabrics or natural-synthetic fabric blends (shirts, blouses).   |
| 5    | Sport          | 30°   | 1000                  | 4              | <input checked="" type="checkbox"/> | <input checked="" type="checkbox"/> | <input checked="" type="checkbox"/> | <input checked="" type="checkbox"/> | <input checked="" type="checkbox"/> | <input type="checkbox"/>            | <input checked="" type="checkbox"/> | <input type="checkbox"/>            | 02:00        | 0,622                    | 50                    | 2                | Sports wear and leisure wear with Microfibre.  |
| 6    | Outdoor        | 30°   | 800                   | 4              | <input checked="" type="checkbox"/> | <input checked="" type="checkbox"/> | <input checked="" type="checkbox"/> | <input checked="" type="checkbox"/> | <input checked="" type="checkbox"/> | <input type="checkbox"/>            | <input checked="" type="checkbox"/> | <input type="checkbox"/>            | 01:31        | 0,615                    | 38                    | 2                | Special programme for washing of outerwear, sports wear, which is often waterproof. With this programme, you can add a hydrophobic coating to the rinse aid compartment. Increases water resistance. |
| 7    | Dark Clothes   | 40°   | 1000                  | 4              | <input checked="" type="checkbox"/> | <input checked="" type="checkbox"/> | <input checked="" type="checkbox"/> | <input checked="" type="checkbox"/> | <input checked="" type="checkbox"/> | <input type="checkbox"/>            | <input checked="" type="checkbox"/> | <input type="checkbox"/>            | 02:26        | 0,796                    | 62                    | 3                | Lightly soiled delicate synthetics, or synthetic and cotton blends.  |
| 8    | Synthetics     | 40°   | 800                   | 4              | <input checked="" type="checkbox"/> | <input checked="" type="checkbox"/> | <input checked="" type="checkbox"/> | <input checked="" type="checkbox"/> | <input checked="" type="checkbox"/> | <input type="checkbox"/>            | <input checked="" type="checkbox"/> | <input type="checkbox"/>            | 02:17        | 1,05                     | 70                    | 3                | Dirty cotton, synthetics, coloured laundry, linen fabrics.   |
| 9    | Drum Clean     | 90°   | 600                   | --             |                                     |                                     |                                     |                                     |                                     | <input checked="" type="checkbox"/> | <input checked="" type="checkbox"/> | <input checked="" type="checkbox"/> | 01:18        | 1,047                    | 10                    | 2                | A special programme (no load) that sterilises (90-95°C) and cleans the inner and outer drum from allergens and pathogens like fungi, moulds, bacteria.   |
| 10   | Rinse&Spin     | --  | 1400                  | 8              |                                     |                                     |                                     |                                     |                                     | <input checked="" type="checkbox"/> | <input checked="" type="checkbox"/> | <input type="checkbox"/>            | 00:20        | 0,043                    | 20                    | 1                | This programme is for rinsing with additives (such as anti-static or softening additives). Reduce the spin speed when washing very delicate fabrics.   |
| 11   | Steam Refresh  | --  | --                    | --             |                                     |                                     |                                     |                                     |                                     | <input checked="" type="checkbox"/> | <input checked="" type="checkbox"/> | <input checked="" type="checkbox"/> | 00:15        | 0,395                    | 1                     | --               | This special program do not use water for classic washing. It only use steam to refresh your laundry. You can easily get rid of bad odors or just make fresh again your lightly used shirts          |
| 12   | Wool           | 40°   | 600                   | 2              |                                     |                                     | <input checked="" type="checkbox"/> | <input checked="" type="checkbox"/> |                                     | <input checked="" type="checkbox"/> | <input checked="" type="checkbox"/> | <input type="checkbox"/>            | 01:07        | 0,444                    | 26                    | 2                | <b>NOTE:</b> Do not machine wash woollen fabrics if the cloth tag prohibits.   |
| 13   | Delicate       | 30°   | 600                   | 2,5            |                                     |                                     | <input checked="" type="checkbox"/> | <input checked="" type="checkbox"/> |                                     | <input checked="" type="checkbox"/> | <input checked="" type="checkbox"/> | <input type="checkbox"/>            | 00:50        | 0,348                    | 29                    | 2                | Very delicate fabrics, e.g. silk.  |
| 14   | Quick Wash     | Cold water                                  | 800                   | 2              |                                     |                                     | <input checked="" type="checkbox"/> |                                     |                                     | <input checked="" type="checkbox"/> | <input checked="" type="checkbox"/> | <input type="checkbox"/>            | 00:15        | 0,158                    | 26                    | 1                | Lightly soiled, sweaty cotton and linen clothes. <b>NOTE:</b> Due to the extra short wash cycle, less detergent is required compared to other programmes.  |
| 15   | Anti-Allergy   | 60°   | 800                   | 4              |                                     |                                     |                                     | <input checked="" type="checkbox"/> |                                     | <input type="checkbox"/>            | <input checked="" type="checkbox"/> | <input type="checkbox"/>            | 04:41        | 2,5                      | 90                    | 4                | The program is designed for washing clothes of people with sensitive skin, eg. for children.   |
| 16   | My program     | To save frequently used programme settings. |                       |                |                                     |                                     |                                     |                                     |                                     |                                     |                                     |                                     |              |                          |                       |                  |  |

\* Standard programmes for washing cotton fabrics at 60 °C and 40 °C. These programmes are suitable for washing normally soiled cotton fabrics. These are the most effective programmes for washing these type of fabrics, taking into account the total energy and water consumption.

**NOTE:** Real water temperature may differ from the declared wash cycle temperature.

**NOTE:** Above mentioned time is an estimate and may differ from actual wash cycle time, depending on temperature, water pressure, load size, etc. The time is automatically updated during wash cycle. Displaying the same time for an extended period or abrupt changes are normal.

○ Use detergent or fabric softener if necessary,

● Detergent required, without which washing will be ineffective.

✗ Do not use detergent or fabric softener