



AEC60SS

AEC90SS

Curved glass extractor

Use and maintenance

Contents

3	Important information
5	Using your extractor
6	Care and maintenance
7	LED lighting
8	Mains electricity connection
9	Troubleshooting
10	Mounting your extractor
11	Installation

Important information

The CDA Group Ltd cannot be held responsible for injuries or losses caused by incorrect use or installation of this product. Please note that CDA reserve the right to invalidate the guarantee supplied with this product following incorrect installation or misuse of the appliance or use in a commercial environment.

This appliance is not designed to be used by people (including children) with reduced physical, sensorial or mental capacity, or who lack experience or knowledge about it, unless they have had supervision or instructions on how to use the appliance by someone who is responsible for their safety.

Under no circumstances should any external covers be removed for servicing or maintenance except by suitably qualified personnel.

Appliance information:

Please enter the details on the appliance rating plate below for reference, to assist CDA Customer Care in the event of a fault with your appliance and to register your appliance for guarantee purposes.

Appliance Model	
Serial Number	

Declarations of Conformity:

This appliance has been manufactured to comply with all EU & UK statutory requirements and complies with all applicable legislation and the following European Directives:

- The Low Voltage Directive 2014/35/EU
- Electromagnetic Compatibility Directive 2014/30/EU

The product has been marked with the UKCA and CE symbols.



This appliance is marked according to the European directive 2004/104/EC on Waste Electrical and Electronic equipment (WEEE):

IMPORTANT INFORMATION FOR CORRECT DISPOSAL OF THE PRODUCT IN ACCORDANCE WITH EC DIRECTIVE 2012/19/EU.

At the end of its working life, the product must be taken to a special local authority waste collection centre or to a dealer providing appliance recycling services.

Disposing of a household appliance separately avoids possible negative consequences for the environment and health. It also enables the constituent materials to be recovered, saving both energy and resources. As a reminder of the need to dispose of household appliances separately, the product is marked with a crossed-out wheeled dustbin.

Please note:

- Under no circumstances should the extractor be connected to any gas ventilation system, flue system or hot air ducting system.
- Do not vent the extractor into an attic or loft space.
- Only house the extractor in rooms with adequate ventilation. Remember that the extractor is powerful and whatever air is extracted needs to be replaced.
- Do not tile the extractor in. It should be removable for service or maintenance.
- Do not use silicone sealant to secure the hood to the wall.
- You must be able to isolate the extractor from the mains electrical supply after installation.
- This extractor has been designed to be used in a room with a volume of less than 36m³.
- Steam cleaners must not be used when cleaning this appliance.
- The performance of your extractor will vary depending on a number of factors. These include: type of extraction, length of ducting, room volume, ventilation available and cleanliness of the filters.

Using your extractor

For best performance, you should switch on the extractor 15 minutes before starting to cook and leave it to run for approximately 15 minutes after the end of cooking.

Control Panel

A - Power off button

B - Speed level buttons

C - Light button

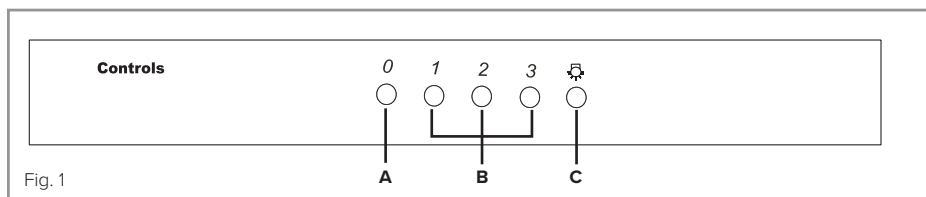

To switch the extractor light on or off

- Press button "C".

To switch on the extractor or to change the speed at any time when the extractor is running

- Press the relevant "B" button for the first, second or third speed level as required.

To switch the extractor off

- Press the "A" button.

Care and maintenance

IMPORTANT : DO NOT PERFORM MAINTENANCE OR CLEANING OF THE EXTRACTOR WITHOUT FIRST SWITCHING OFF THE ELECTRICITY SUPPLY.

Cleaning

You should use a non-abrasive cleaner. Any abrasive cleaner (including Cif) will scratch the surface and could erase the control panel markings.

You can clean your extractor effectively by simply using a dilute solution of water and mild detergent and drying to a shine with a clean cloth, for example a microfibre cloth.

Cleaning the grease filter

The grease filter should be kept clean to minimise the risk of fire.

At least once a month you should remove and clean the grease filter with hot soapy water. You can also wash the grease filter in a dishwasher, ensuring that you place it in an upright position to prevent damage from other items in the dishwasher.

To remove the grease filter, push in the button on the handle and then pull outwards on the filter as shown in Fig. 2. When you have released it at the front, you can pull the filter out completely.

After rinsing and drying, reassemble the grease filter to the hood by reversing the removal process.

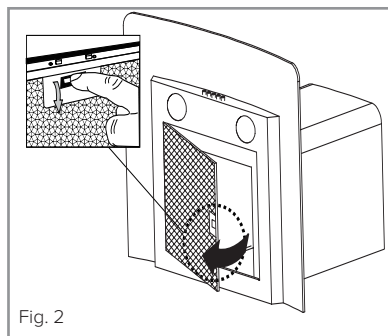

Please note:

Cleaning the grease filter in the dishwasher may lead to discolouration. This is normal and does not constitute a fault with the appliance.

Changing the charcoal filter (re-circulating only)

To ensure best performance of your extractor, you should replace the charcoal filter every four to six months, depending on use.

To attach a new charcoal filter, first remove the grease filters as described on the previous page.

To attach the charcoal filter

Offer up the charcoal filter as shown in Fig. 3 so that the magnetic pins are facing upwards one to the rear and one to either side. The filter will be held in place by magnetic force. Finally replace the grease filters.

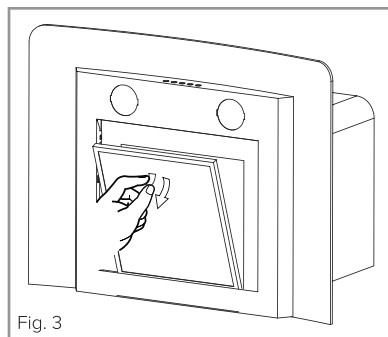

LED lighting

In case of malfunction of the illumination system contact the technical service.

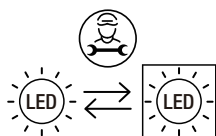

Replaceable (LED only) light source by a professional

Mains electricity connection

THIS APPLIANCE MUST BE CONNECTED TO THE MAINS SUPPLY BY A COMPETENT PERSON, USING FIXED WIRING VIA A DOUBLE POLE SWITCHED FUSE SPUR OUTLET AND PROTECTED BY A 3A FUSE.

We recommend that the appliance is connected by a qualified electrician, who is a member of the N.I.C.E.I.C. and who will comply with the I.E.T. and local regulations.

The wires in the mains lead of this appliance are coloured in accordance with the following code:

Green & Yellow = Earth

Blue = Neutral

Brown = Live

As the colours of the wires in the mains lead for the appliance may not correspond with the coloured markings identifying the terminals connecting to the fuse spur, proceed as follows:

- The wire which is coloured GREEN and YELLOW must be connected to the terminal marked E (Earth) or coloured GREEN and YELLOW
- The wire which is coloured BLUE must be connected to the terminal marked N (Neutral) or coloured BLACK.
- The wire which is coloured BROWN must be connected to the terminal marked L (Live), or coloured RED.

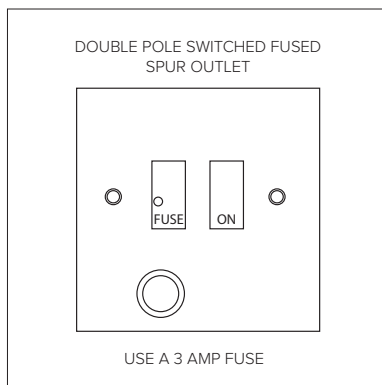

Note: Use a 3A Fuse.

Assembly and electrical connection should be carried out by specialised personnel.

When installing this product we recommend you seek the help of another individual.

Electrical Information

Mains electrical voltage: 230 – 240Vac

Total rated power consumption:

112W

Troubleshooting

Please note:

Your extractor is equipped with a motor protection device that will switch off the motor to prevent damage from overheating. This may happen during cooking when most or all of the zones/burners are being used simultaneously, or if your extractor is installed incorrectly, lower than the recommended height.

This is normal, and the extractor will work again once the motor has cooled sufficiently.

If your extractor is not working:

1. Check that the mains supply has not been switched off.
2. Check that the fuse in the spur has not blown.

Contact CDA Customer Care

A: Customer Care Department, The CDA Group Ltd, Harby Road,
Langar, Nottinghamshire, NG13 9HY

T: 01949 862 012

F: 01949 862 003

E: customer.care@cda.eu

W: www.cda.eu

Mounting your extractor

When the extractor is to be installed above an Amica hob, the minimum distance between the hob and the extractor must exceed 550mm.

If the instructions provided with another brand of gas hob state that the required distance between the hob and the extractor must be greater than 550mm, then that is the distance that should be observed; this is a legal requirement and may lead to your hob being disconnected from the gas supply and the installation being reported under RIDDOR.

Note: The height should be measured from the top of the burners.

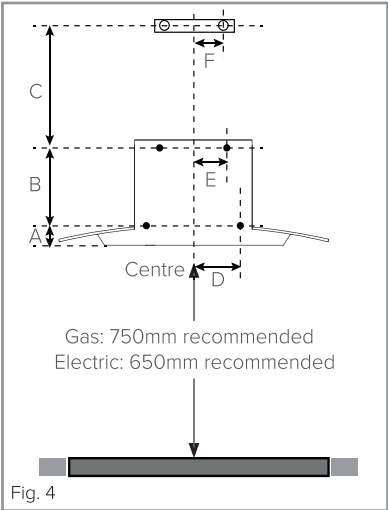

IN THE ABSENCE OF ANY INSTRUCTIONS SUPPLIED WITH THE GAS HOB, THE MINIMUM DISTANCE BETWEEN THE HOB AND THE EXTRACTOR MUST BE AT LEAST 760mm.

The width of any hob must not be greater than the width of the extractor installed above it.

Ducting and ventilation

For best performance and lowest noise output we recommend the use of 150mm ducting. 125mm ducting may be used but this will reduce performance and increase the noise of the extractor.

AEC60SS / AEC90SS	
A	53mm
B	155mm
C	Height dependent
D	105mm
E	105mm
F	73mm

Wherever possible use the rigid circular pipe which has a smooth interior, rather than the expanding concertina style ducting. The lengths of ducting without performance being affected are as follows:

- 4 metres with 1 x 90° bend
- 3 metres with 2 x 90° bends
- 2 metres with 3 x 90° bends

Installation

The metal casing of this appliance has been coated with a preservative to protect it during transport and storage. This should be removed during installation by using a non-abrasive stainless steel cleaner. Always follow the instructions given with the cleaner being used. Please ensure that there is no power being supplied to the appliance whilst you do this.

When correctly installed, your product meets all safety requirements laid down for this type of product. However, special care should be taken around the rear of the appliance as these areas are not designed nor intended to be touched and may contain sharp or rough edges that could cause injury. Always wear adequate Personal Protective Equipment (PPE).

Note:

- We recommend that you seek the help of another individual when installing this product
- The fixings supplied are suitable for most installations. It is the responsibility of the installer to ensure that the fixings are suitable for the ceiling type in the property
- Please cover any hob or surface below the area in which the extractor is to be installed, so that no damage befalls it

Tools required

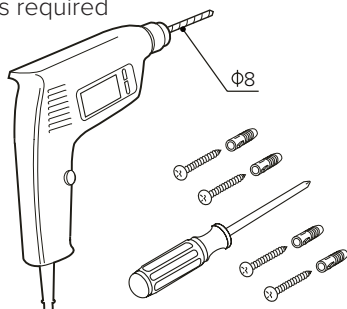

Fig. 5

Mark out wall as required, see Fig 4.

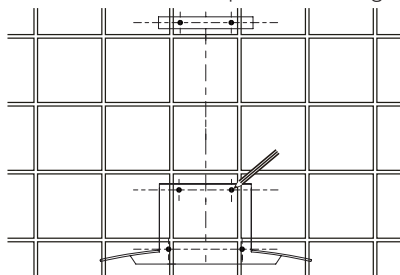

Fig. 6

Drill holes

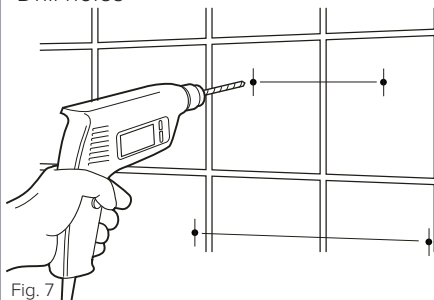

Fig. 7

Fit wall fixings and top screws - Ensure that any fixings you use are appropriate for the wall type.

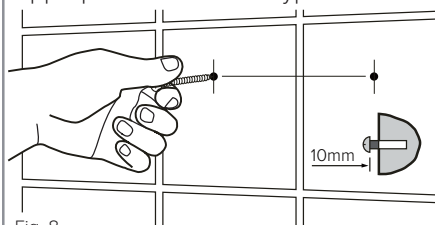

Fig. 8

Secure hood (tighten all screws)

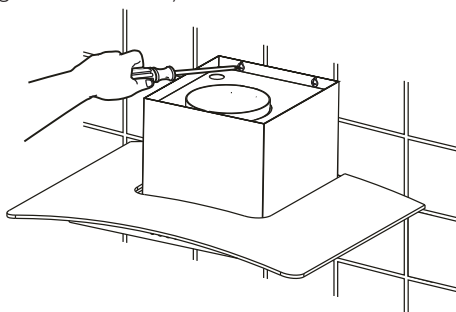

Fig. 9

IMPORTANT SAFETY WARNING:

ONLY USE THE SCREWS PROVIDED WITH THE EXTRACTOR TO MOUNT THE DUCTING ADAPTOR. THE USE OF LONGER SCREWS MAY CAUSE DAMAGE TO THE INTERNAL WIRING WHICH WILL NOT BE COVERED BY THE WARRANTY.

Note: If you are using the supplied ducting adaptor to reduce the diameter from 150mm to 125mm, secure this in before continuing to Fig. 11

Mount chimney brackets.

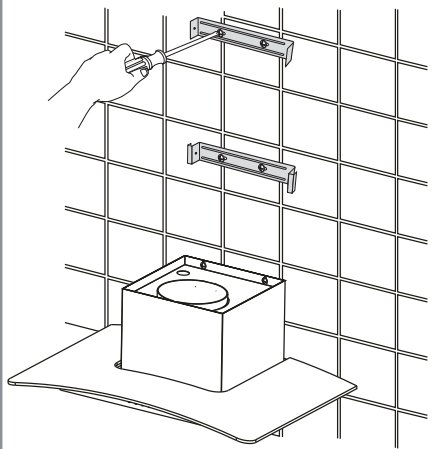

Fig. 10

Fix ducting (seal joint)

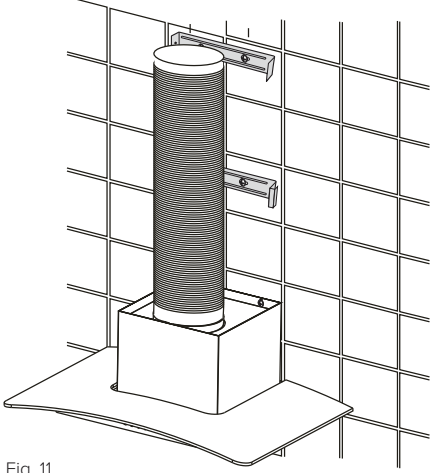

Fig. 11

Mount the chimney.

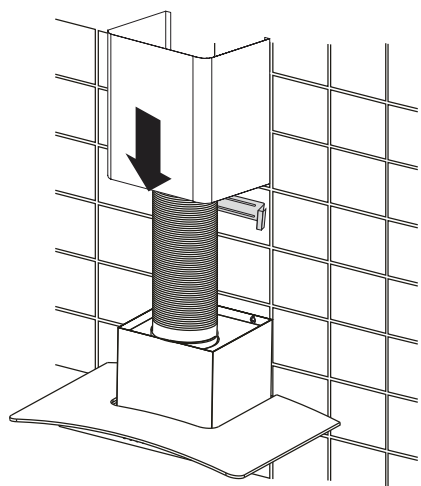

Fig. 12

Adjust and secure the chimney.

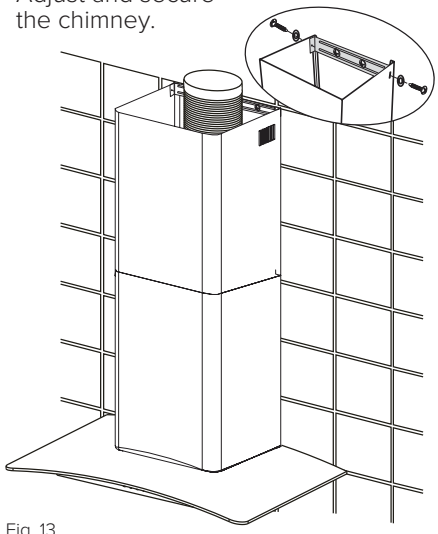

Fig. 13

ENERGY EFFICIENCY INFORMATION

Energy Efficiency Information		
Attribute	Symbol	Value
Annual Energy Consumption	AEC_{Hood}	37.5kWh
Time increase factor	f	1.3
Fluid Dynamic Efficiency	FDE_{Hood}	18.3
Energy Efficiency Index	EEL_{Hood}	65.1 (B)
Measured airflow at Best Efficiency Point	Q_{BEP}	221.1m ³ /h
Measured Pressure at Best Efficiency Point	P_{BEP}	217 Pa
Maximum airflow	Q_{MAX}	418.1m ³ /h
Measured electric power at Best Efficiency Point	W_{BEP}	72.9 W
Normal lighting power	WL	4W
Average illumination of lighting system in the cooking surface	E_{Middle}	546 Lux
Measure power consumption in standby	P_S	N/A
Measure power consumption off mode	P_O	0
Sound power level	L_{WA}	67dBA
Grease Filter Efficiency	GFE_{Hood}	70.1% (D)
Lamp Efficiency	LE_{Hood}	136% (A)

E & O E. All instructions, dimensions and illustrations are provided for guidance only. Amica reserve the right to change specifications without prior notice.

Amica
The CDA Group Building

Harby Road
Langar
Nottinghamshire
NG13 9HY

Sales Department
Phone: 01949 862010

Amica Customer Care
Phone: 01949 862012
Email: customer.care@cda.eu

